

Barn Registration Program

Thank you for your interest in the McHenry County Historical Society's Barn Registration Program. Unfortunate as it is, this program may become the only record of barns that once predominated in McHenry County.

This registration program, which started in 1999, will continue over many years to collect information on all types of barns - be they dairy barns, carriage barns or abandoned barns. The registration forms will be kept on file at the McHenry County Historical Society Museum's Local History Research Library in Union where they will be preserved and made available for research. A Certificate of Registration will be mailed as soon as the application is complete and approved. Participants will be invited to the Society's annual meeting in June for recognition.

It is important to include as much information as possible on each of the barns and barn builders, so participants are urged to be as thorough as possible in filling out the form. Assistance is available through the Historical Society. The Society does reserve the right to withhold the certificate because of insufficient information.

Registration criteria is as follows:

1. Any and all barns within the geographical limits of McHenry County qualify for listing.
2. No fee is charged for filling out the form with no certificate issued or for filling out the form on abandoned barns or barns that no longer exist.
3. If a frameable Certificate of Barn Registration is desired, there is a \$5.00 processing fee for each one.
4. Only one barn may be listed on each form.
5. There is no limit to the number of barns submitted by an individual.



Please contact the McHenry County Historical Society for further clarifications, additional information, and/or a willingness to help at 815-923-2267 or info@mchsonline.org.

Application for the Barn Registration

General Information

Applicant Name (s): _____

Address: _____

Phone: _____

Application Date: _____

Is the applicant also the owner of the property? Yes _____ No _____

If no, please provide the following information:

Owners Name: _____

Address: _____

Phone: _____

Barn Pictures: (No Polaroids; color Xerox acceptable) Please furnish both new and old photographs, if available, giving the approximate date the pictures were taken. What side of the barn is the picture taken of:

North _____ South _____ East _____ West _____

Barn History and Information

Address of the barn: _____

Township: _____

Current Zoning: _____

Age of barn (if known): _____

Dimensions (a rough sketch drawn on the back side of this sheet of the barn layout with dimensions would be helpful): _____

Living relatives of the builder (if known): _____

Who owned the farm when it was built? _____

Was there a previous barn on the farm? - If so, what happened to it? _____

Was the original foundation used for the present barn? _____ If not, is that foundation still visible? _____

Other historical information will be appreciated (for example, whether moved, gone through tornado or fire, underground RR stations, describe additions): _____

Barn Characteristics

(see addendum for definitions and roof style sketches)

Please Check All That Apply

Plan Type:

Rectangular ___ "L" shape ___ "T" shape ___ Round ___ Multi-sided ___

Combination -- describe: _____

Foundation:

Stone ___ Concrete ___ Concrete block ___ Columns (piers) ___ Columns/wood piers ___

Columns/stone piers ___

Type of Construction:

Post and beam (pegged) ___ Post and beam (nailed) ___ Laminated arches ___

Ceiling trusses made from milled lumber ___ Side wall framing made from milled lumber ___

Masonry ___ Combination of -- describe: _____

Exterior Surfaces *siding*:

Vertical boards ___ Boards & battens ___ Horizontal boards ___ Stucco ___ Asbestos shingles ___

Asphalt shingles ___ Poured concrete ___ Brick ___ Prefabricated (e.g., Sears) ___ Metal ___

Concrete block ___ Poured concrete ___

Combination of siding -- describe: _____

Has the barn ever been resided? _____

What was the original siding? _____

Roof Style:

Gable ___ Extended gable ___ Gable shed ___ Hip ___ Gable on hip ___ English gambrel ___

Dutch gambrel ___ Saltbox ___ Gothic (round roof) ___ Monitor ___ Snug Dutch (snub nose) ___

Combination of -- describe: _____

Roofing:

Wood shingles ___ Asphalt shingles ___ Roll roofing ___ Metal ___ Slate ___

Type of Ventilation:

Wood cupolas ___ Metal cupolas ___ Gable-end louvers ___ Ridge vents ___ Dormers ___

Other _____

Decorative Features:

Hex signs ___ Round windows ___ Decorated barn doors ___ Painted murals ___ Advertising ___

Center opposing doors ___ Other _____

Barn Categories (check those that apply):

Active working barns: Dairy ___ Horse ___ Feeder ___ Pig ___ Other ___

Inactive barns: Storage ___

Barn Conversions: Home ___ Office ___ Retail business ___ Church ___ Municipal/Civic ___

Conservation or park ___ Garage/workshop ___

Conversion Date: _____

Is the present structure in its original location? Yes ___ No ___

If no, where was the structure relocated from? _____

Who moved or converted it? Please give as much information as possible: _____

Tired and Retired Barns

If you have salvageable materials and you would like to be contracted about those materials, please sign your name and provide a phone number. The McHenry County Historical Society will pass that information on when it receives inquiries:

Carriage Barns:

Condition (check one): Excellent ___ Good ___ Fair ___

What is its present use? _____

List the present types of materials used on:

Foundation: _____

Siding: _____

Roofing: _____

Windows: _____

Doors: _____

Other: _____

Are any of the above mentioned materials replaced materials? _____

If so, what were the original materials? _____

Secondary buildings of interest on the property (check those that apply and give age if known):

Milk House: Attached _____ Free standing _____

What is the type of construction? _____

Silo: Wood stave _____ Concrete stave _____ Poured concrete (reinforced) _____ Brick _____

Stone _____ Metal/fiberglass _____ Clay tile _____ Combination _____

Granaries _____ **Machine Sheds** _____ **Chicken House** _____ **Out House (privy)** _____

Corn crib _____ **Other:** _____

The contents of this barn registration form application are the sole ownership of the McHenry County Historical Society. The material contained herein shall be made available for research by qualified persons determined by the Society. Thereafter, the materials may, with the Society's written permission, be copied, reproduced and/or published.

For office use only:

Registration only _____

Certificate of Registration _____

\$5.00 processing fee included _____ Barn type _____ Rev. 2001

BARN ROOFS

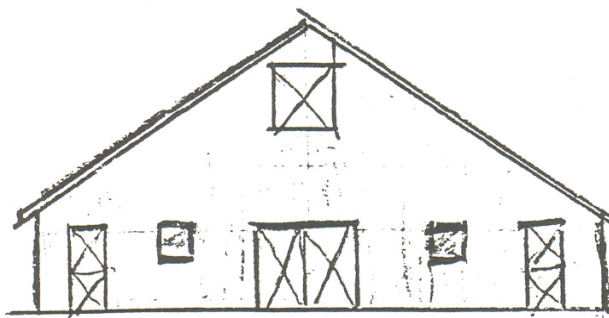
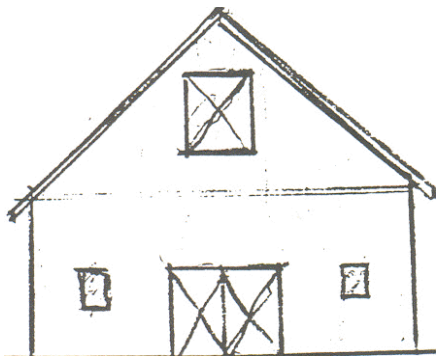

Gable End

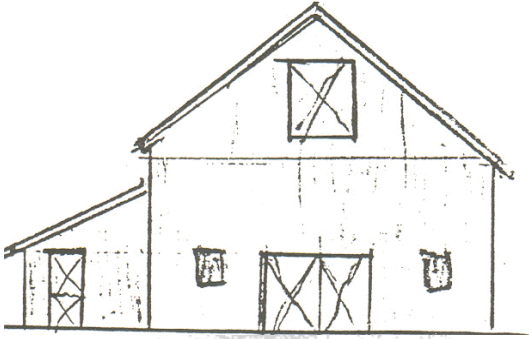

Gable Shed

Extended Gable (Western)

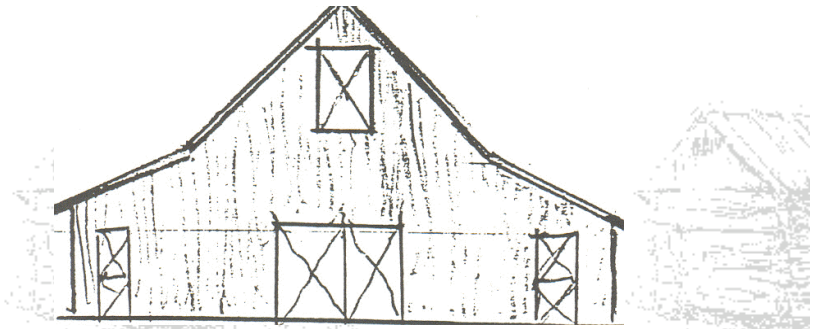

Broken Gable

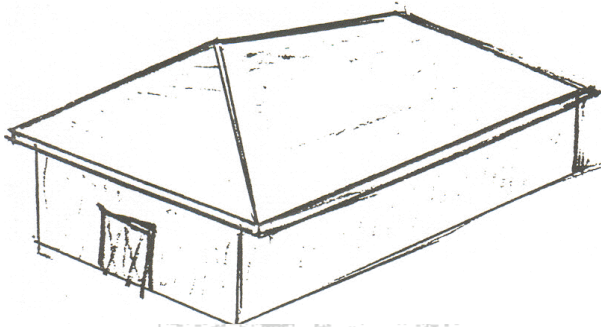

Hip

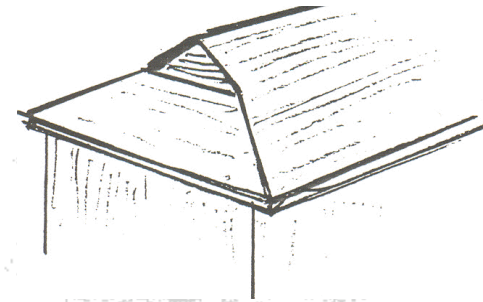

Gable on Hip

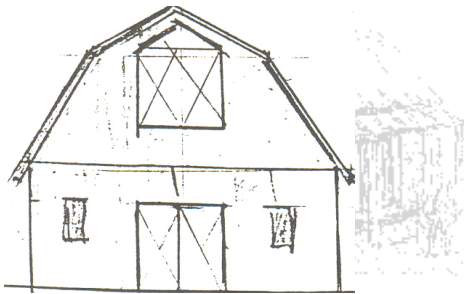

English Gambrel

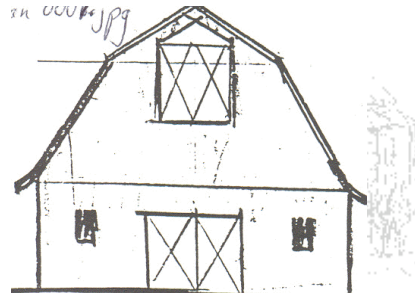

Dutch Gambrel

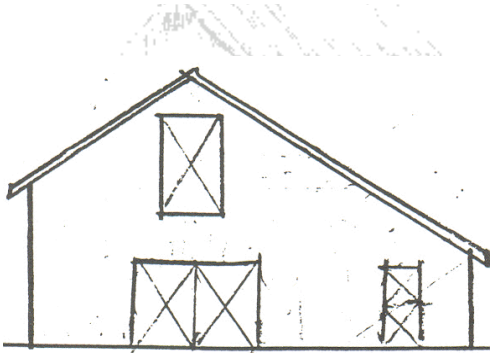

Salt Box

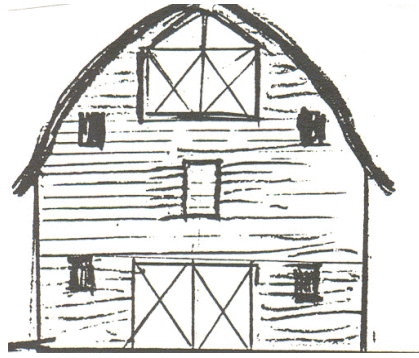

Gothic (Round Roof)

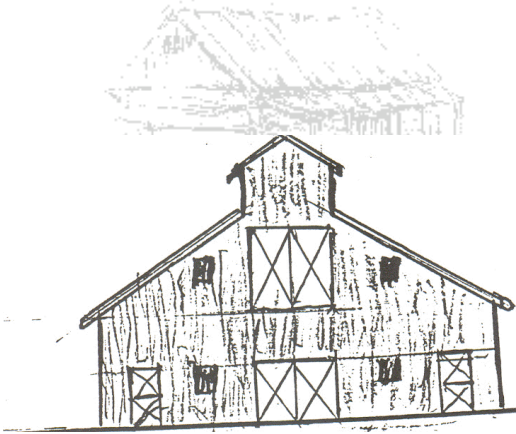

Monitor



Half Monitor

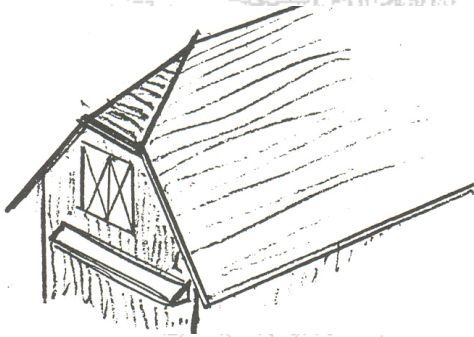

Snug Dutch (Snub Nosed)